

# SJF-RL200 Gym Floor System

## Technical Data Sheet

CMS Danskin Acoustics SJF-RL200 Gym Floor System consists of a seamless floor finish and resilient layer over a floating sprung concrete jack up floor.

Rating generally according to  
BS EN ISO 717-2 standardised A-weighted  
maximum impact sound pressure levels,  $L_{IA,Fmax,V,T}$

**53dB** (36kg weight drop)  
**47dB** (20kg weight drop)

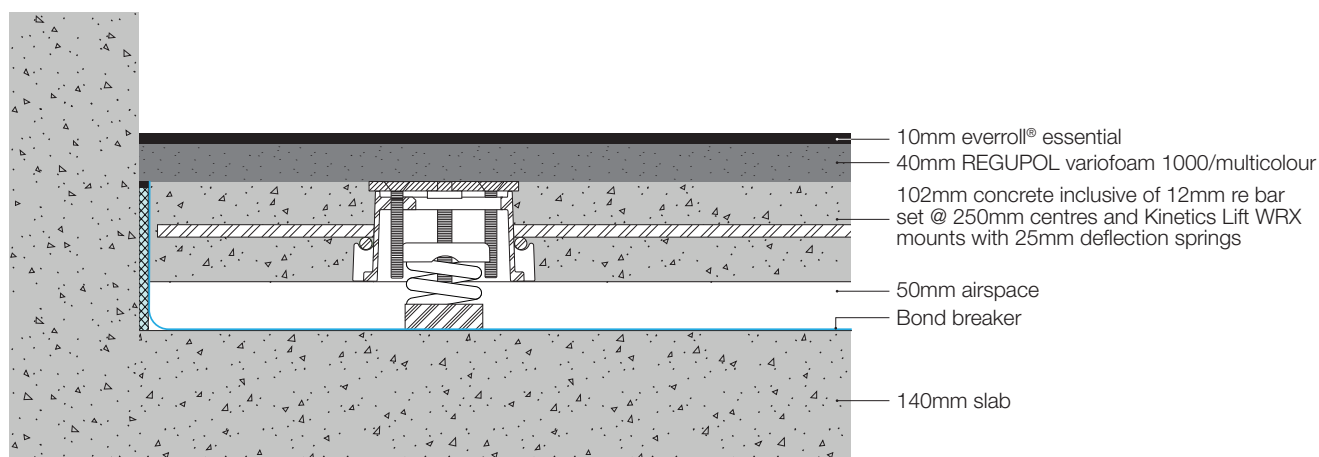

### FEATURES and BENEFITS

- Provides a seamless floor finish
- Low profile resilient layer system over high-performance floating floor
- Various colour finishes available (see colour chart)

### PHYSICAL PROPERTIES

- A top finish floor layer of Everroll which is a 10mm thick, PUR bonded blend of SBR rubber crumb and EPDM granulate available in plain Black and Black with a percentage of Grey EPDM granulate. Other colour options are available.
- A second layer of REGUPOL Variofoam 1000 which is a 40mm thick recycled foam product providing a firm but resilient underlay to the system.

10mm everroll® essential	ROLL 10m x 1.25m x 10mm
40mm REGUPOL variofoam 1000	SHEET 2m x 1m x 40mm
Kinetics Lift WRX Mounts	186mm (L) x 164mm (W) x 102mm (H) available with 25mm or 50mm spring deflection rate

- This is laid over the Kinetics Lift WRX System which is a spring jack up concrete floor with isolators connected using 12mm re bar and 102mm thick concrete.
- This is lifted once cured to create a 50mm airspace beneath the floating concrete and is supported by specifically selected springs.

For further individual product information, technical data sheets are available on request for each of the layers.

Please also see installation guidance.

## TESTING

Tests have been carried out at a Laboratory to determine the maximum impact sound pressure levels of various resilient layers and floating floor systems on top of a 140mm thick solid concrete floor following the principles of BS EN ISO 10140-3:2021 Annex A.

The results are given in 1/3rd octave bands over the frequency range 20Hz to 10kHz. For the tests a 20kg and/ or 36kg kettlebell was dropped from a height of 500mm using a hoist.

Lab conditions did not allow a direct drop onto the concrete. 10mm everroll was used as a worst-case scenario.

Some resilient gym floor systems require the use of spreader plates beneath the feet or legs of heavy kit and equipment for stability.

This should be assessed by the kit and equipment suppliers, floor samples are available if required.

The acoustic performance shown is not necessarily transferable to other structural concrete floors.

The positioning of columns, thickness of structural floors, size of structural floor spans, ceiling types and other elements can all influence performance.

This data should be considered by your project acoustic consultant.

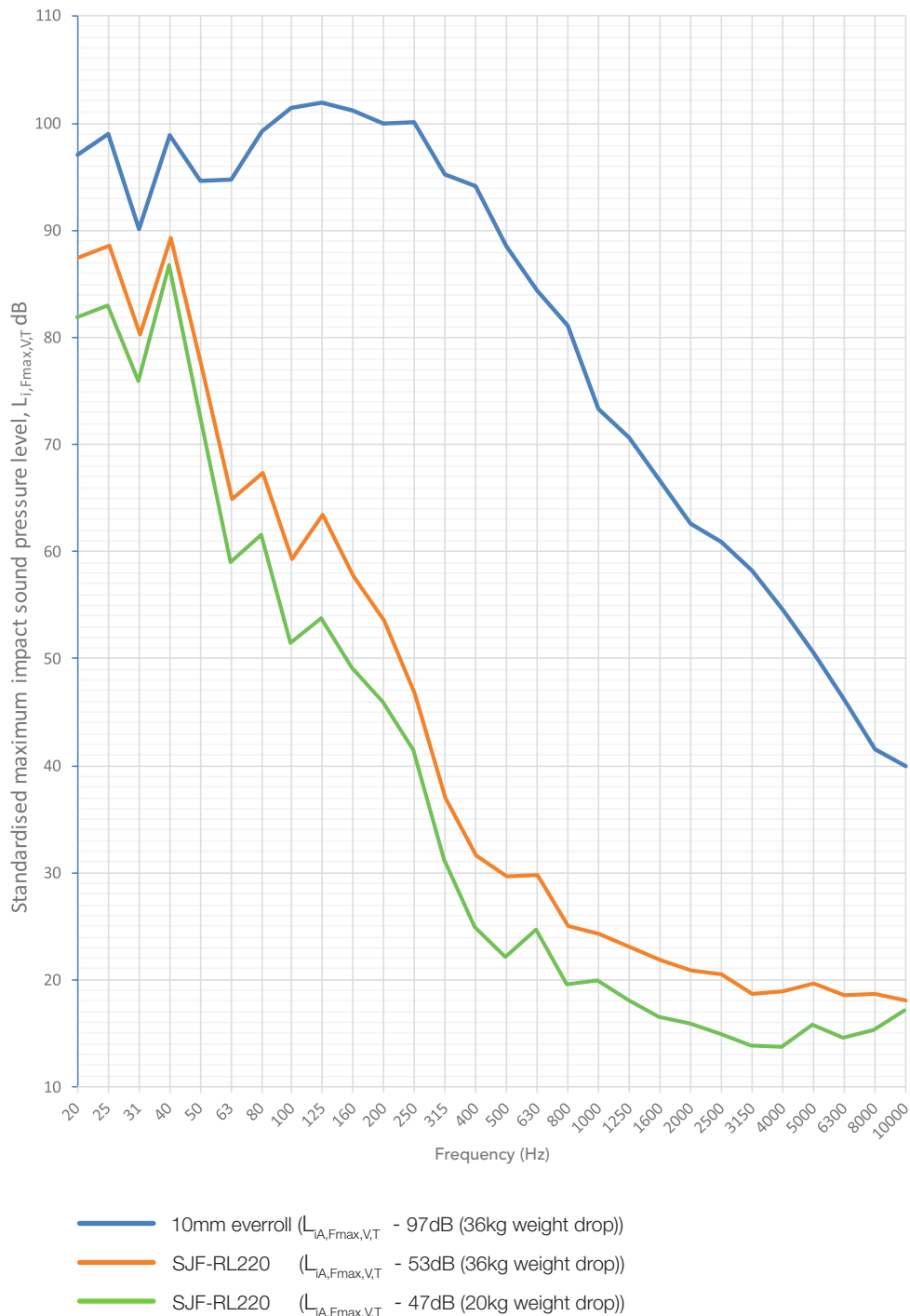

## ROLLS & FLOOR BUILD-UPS

Colours & Decors

### REGUPOL everroll ultimate range\* (other colours available upon request)

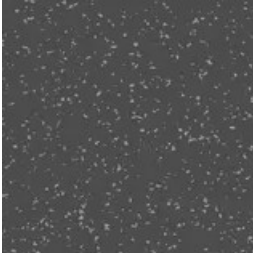

Orleans (1372)

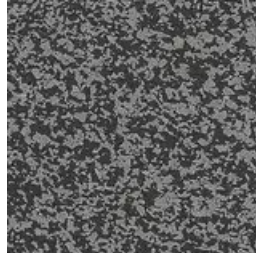

Ottawa (1369)

### REGUPOL everroll essential range\* (other colours available upon request)

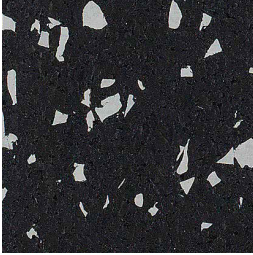

Berlin (3195)

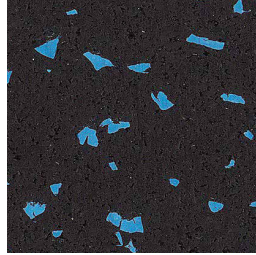

Palau (3146)



Helsinki (3196)



Glasgow

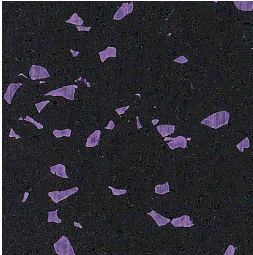

Bilbao (3159)

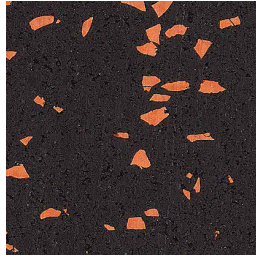

Amsterdam (3185)



Kush (3150)

Deviations from the colours shown are possible due to variation in batches and print reproduction.

\* Wherever direct, prolonged or repeated skin contact can be expected, the requirements for a Consumer Product currently valid within the EU must be met. Where this is not expected, your choice can be made from the entire decor portfolio. Those products the manufacturer has identified as fulfilling the requirements of a Consumer Product, are explicitly marked as such. To aid your choice the manufacturers recommended everroll wear layer has been tabulated.

Application	everroll wear layer
<ul style="list-style-type: none"> <li>• CrossFit</li> <li>• Functional Training</li> </ul>	Ultimate
<ul style="list-style-type: none"> <li>• Cardio</li> <li>• Free-weights</li> <li>• Lifting Platforms</li> <li>• Machine Training</li> <li>• Spin Studios</li> </ul>	Essential, Classic or Ultimate
<ul style="list-style-type: none"> <li>• Changing Rooms</li> <li>• Martial Arts Studios</li> <li>• Physiotherapy Rooms</li> <li>• Yoga Studios</li> </ul>	NOT RECOMMENDED