

## TECHNICAL DATA

### REGUPOL SOUND AND DRAIN 22

#### Product

Impact sound reducing underlayment for various floor structures on terraces, loggias and balconies, serving simultaneously as rainwater drainage and membrane protection.



#### Material

- Polyurethane elastomer composite
- Dimpled profile on the underside
- Geotextile-laminated on top (160g, GRK 4)

#### Applications

- Terraces
- Loggias
- Balconies
- Rooftops
- Arcades



#### Compatibility

Compatible with commercially available

- Bitumen and EPDM based membranes
- PVC membrane, if approved by the membrane manufacturer

If applicable, the thermal insulation should have a compressive strength of minimum 300 kPa.

#### Physical information

Roll width	1250mm	
Roll length	10m	
Material thickness	15mm	
Weight per roll / per m <sup>2</sup>	81kg	6.5kg/m <sup>2</sup>
Material composition	PUR-bonded composite	

Acoustical Performance*	Standard	Result	Comment
53 mm concrete tiles, loose-laid on height-adjustable pedestals, <b>REGUPOL sound and drain 22</b> , 140 mm concrete slab	DIN EN ISO 10140-3 DIN EN ISO 717-2	$\Delta L_w$ 37 dB	Tested by Müller-BBM Report M133001/01
26 mm wooden decking boards on battens, loose-laid on height-adjustable pedestals, <b>REGUPOL sound and drain 22</b> , 140 mm concrete slab	DIN EN ISO 10140-3 DIN EN ISO 717-2	$\Delta L_w$ 28 dB	Tested by Müller-BBM Report M133001/02

Acoustical Performance*	Standard	Result	Comment
20 mm ceramic tiles, loose-laid on height-adjustable pedestals, <b>REGUPOL sound and drain 22</b> , 140 mm concrete slab	DIN EN ISO 10140-3 DIN EN ISO 717-2	$\Delta L_w$ 35 dB	Tested by Müller-BBM Report M133001/05
20 mm ceramic tiles, loose-laid on aluminium joists and height-adjustable pedestals, <b>REGUPOL sound and drain 22</b> , 140 mm concrete slab	DIN EN ISO 10140-3 DIN EN ISO 717-2	$\Delta L_w$ 35 dB	Tested by Müller-BBM Report M133001/06
27 mm wooden decking boards on battens, <b>REGUPOL sound and drain 22</b> , 2 layers bitumen membrane, 120 mm foam glass thermal insulation, bitumen underlay, 150 mm concrete slab	DIN EN ISO 10140-3 DIN EN ISO 717-2	$\Delta L_w$ 30 dB	Tested by ITA Wiesbaden Report 0038.12- P 109
50 mm concrete tiles, 40 mm 2/8 mm fine stone chippings, <b>REGUPOL sound and drain 22</b> , 2 layers of bitumen membrane, 120 mm foam glass thermal insulation, bitumen underlay, 150 mm concrete slab	DIN EN ISO 10140-3 DIN EN ISO 717-2	$\Delta L_w$ 35 dB	Tested by ITA Wiesbaden Report 0039.12- P 109 (test surface for walk-on tests are recommended)

\*Assembly from top to bottom

Material properties	Standard	Result
Maximum traffic load		50 kN/m <sup>2</sup>
Mean dynamic stiffness value	DIN EN 29052-1	$s'_t \leq 21 \text{ MN/m}^3$
Compressibility	DIN EN 12431	$c \leq 2 \text{ mm}$
Compressive stress at 10 % compression	DIN EN 826	$\sigma_{10} = 13 \text{ kPa}$

Fire behaviour	Standard	Result
Fire classification	DIN EN 13501-1	E (B roof (t1) available on request)

Thermal behaviour	Standard	Result
Thermal conductivity	DIN EN 12667	$\lambda = 0.075 \text{ W/(mK)}$
Thermal resistance	DIN EN 12667	$R = 0.229 \text{ (m}^2\text{K)/W}$
Temperature resistance		-20 to +60° C

Resistance to ageing	Standard	Difference of compressive stress at 10 % compression	Difference of dynamic stiffness
Resistance to oxidation	DIN EN ISO 13438	≤ 1 kPa	≤ 3 MN/m <sup>3</sup>
Resistance to hydrolysis	DIN EN 12447	≤ 3 kPa	≤ 1 MN/m <sup>3</sup>
Ozone resistance	DIN EN 1844	≤ 3 kPa	≤ 3 MN/m <sup>3</sup>
Resistance to weather	DIN EN 12224	≤ 1 kPa	≤ 1 MN/m <sup>3</sup>

Moisture behaviour	Standard	Result	Comment
Water vapour permeability	DIN EN ISO 12572	$S_d = 0.05$ [m]	Diffusion equivalent air layer thickness
		$\mu = 3.1$ [-]	Diffusion resistance factor, Material is open for diffusion
Water flow capacity	DIN EN ISO 12958	2 kPa: 0.144 l/(m·s) 10 kPa: 0.071 l/(m·s) 20 kPa: 0.025 l/(m·s)	Gradient of 1.5 %
		2 kPa: 0.109 l/(m·s) 10 kPa: 0.052 l/(m·s) 20 kPa: 0.018 l/(m·s)	Gradient of 1.0 %
Freeze/thaw resistance	DIN EN 12091		Tested according to standard

## Floor Assembly

### Concrete tiles on pedestals

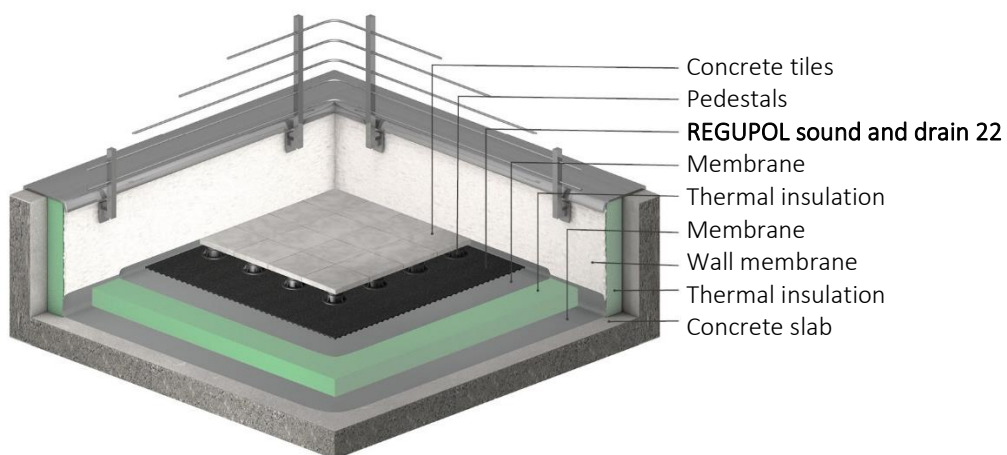

**Floor Assembly**

Concrete tiles on fine stone chippings

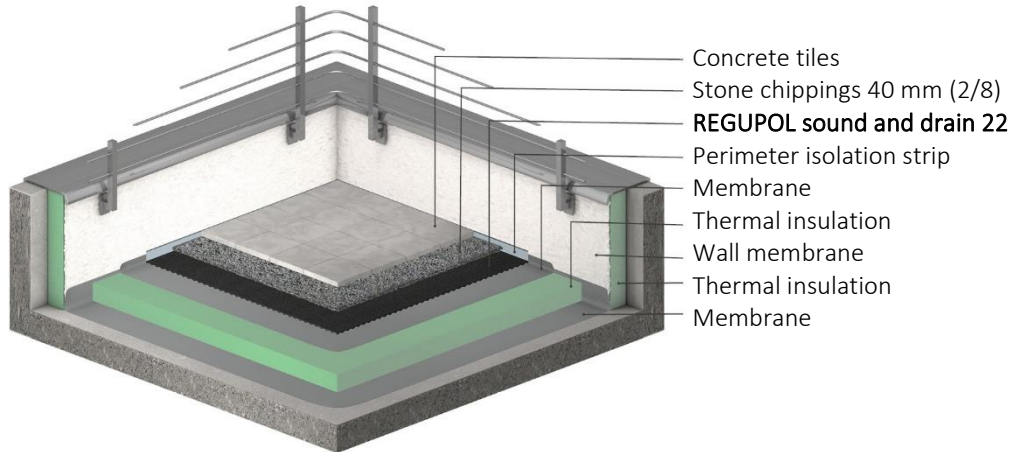

**Floor Assembly**

Wooden decking boards on battens

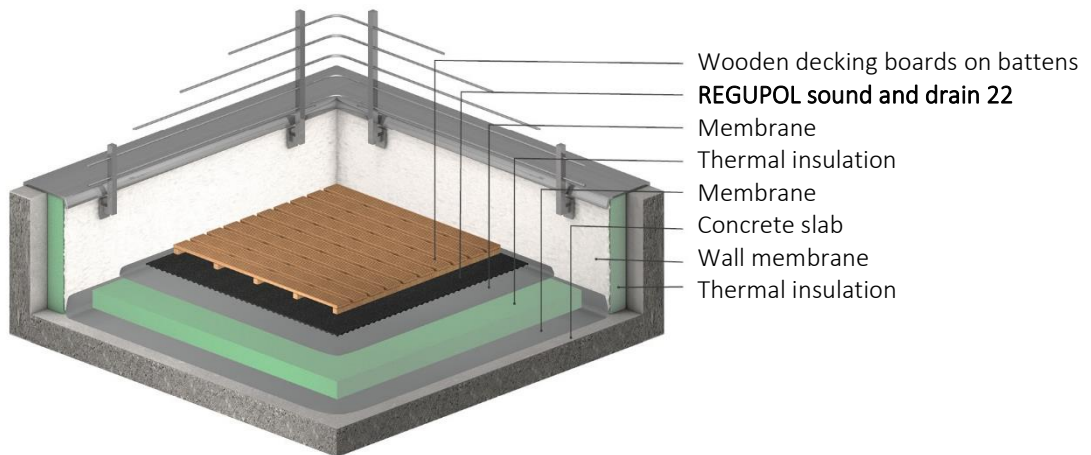

## Floor Assembly

### Ceramic tiles on pedestals

---

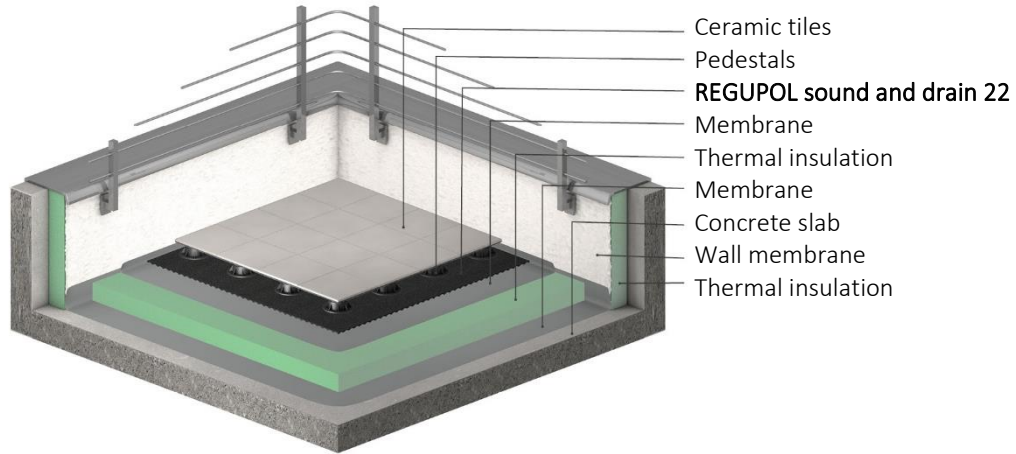

**IMPORTANT:** The information provided within this document is believed correct and to the best of our available knowledge at its revision date and is provided as suggestion for safe handling, storage, transportation, use and disposal. The information should not be considered obligation in respect of warranty of (technical) performance, quality (specification) or suitability for any application or design. The customer must satisfy themselves the product (or draft specification) are relevant and suitable for their need and design intent. Prospective users should test a sample of product under their own conditions to satisfy themselves of its suitability for intended purpose and that expert advice be sought where different applications are contemplated. Due to our policy of continuous improvement we reserve the right to alter or amend published specification or design without prior notice. Reproduction of any part of this publication in any manner is not permitted without our prior written consent.