

Installation Guide

SuperPhon Hardface is a highly sound-absorbent acoustic treatment encased in perforated, galvanised steel or aluminium, making it suitable for high-traffic areas and environments where vandalism may be an issue, such as prisons, police stations and industrial areas.

INSTALLATION GUIDELINES

Vertical Installation using U Channel Secret Fix (Demountable)

- 'U' Channels are to be located on the substrate with suitable fixings to suit background in a location that is appropriate to the desired installation. Fixings should be applied through the long leg of the channel as the installation guide shows.
- Vertical installation of SuperPhon Hardface secret fix installation uses top and bottom channels that allow panels to be lifted into the top channel and lowered into the bottom channel. The large top channels can be used if desired at each side. This allows a "picture frame" to be constructed and provides some tolerance to the installation as the panels can be adjusted. Installation should start by installing panels to each side of the wall working towards the centre. The last panel can be inserted by adjusting panels either side.
- Panels installed vertically are butt jointed.
- Panels can also be installed and moved along the channels to allow even spacing between panels if a shadow gap appearance is desired.

Options using this system are below but are not easily demountable and only partially secret fixed.

- To prevent unwanted removal of the panels, self drilling screws or rivets can be used through the channel face to secure the SuperPhon Hardface. These fixings are obviously visible.
- It is possible to use the U channel to the bottom (and sides if desired) and Z profile to the top. This then prevents panels from being removed as the Z profile does not allow panel movement upwards preventing panels being lifted and removed. The fixings in the Z profile are visible. Z profile would be the last part of the installation to be fixed.

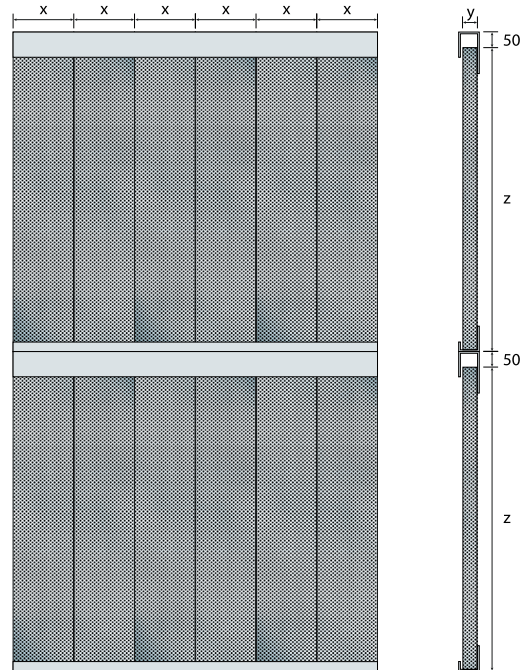

x (width) = 475 / 276 / 426 / 226 / 376 / 176mm
y (thickness) = 50 / 75 / 100mm
z (height) = dependent on height of wall

Typical panel layout when panels need to be installed above each other due to elevation height requiring treatment.

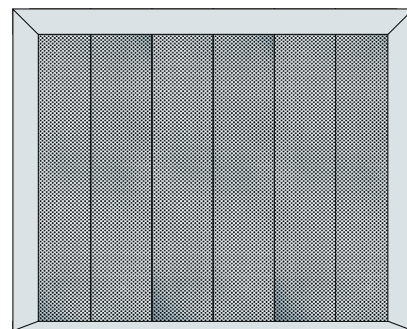

Typical 'picture frame' construction.

Secondary fixings may be required to prevent movement of the panels if contact is made with them.

Please contact your local CMS Danskin Acoustics for further advice.

'U' CHANNEL AND/OR 'Z' CHANNEL OPTIONS

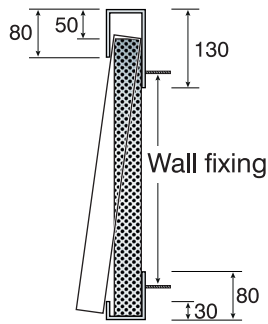

'U' channel fixing method

Horizontal Installation using 'U' Channel
(not available in secret fix)

- 'U' Channels are to be located on the substrate with suitable fixing arrangement to suit background in a location that is appropriate to the desired installation. Fixings should be applied through the long leg of the channel as the installation guide shows.
- Horizontal installation would start from the bottom with the first panel inserted into the large channels to the side and adjusted to ensure the panel ends are within the channel and then lowered into the bottom channel. Subsequent panels are installed, stacking each panel on top of the preceding.
- The penultimate panel should be installed between the side 'U' channels but then pushed up into the top channel. The final panel will then be installed allowing the previous panel to be dropped down on top the stack of panels completing the wall.
- All panels will require self drilling screws or rivets applying through the side 'U' channels to ensure the panels cannot come out of the 'U' channels.

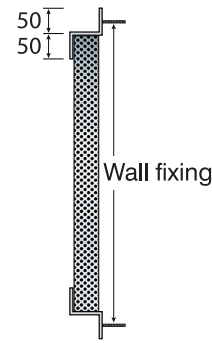

'Z' channel fixing method

Vertical or Horizontal Installation using 'Z' channel
(not secret fix)

- 'Z' Channels are to be located on the substrate with suitable fixing arrangement to suit background in a location that is appropriate to the desired installation. Only apply the 'Z' channel the bottom (or to the bottom and one edge). The 'Z' to the top (and one side) should be the last part of the installation.
- Install SuperPhon Hardface panels in the desired orientation - horizontally or vertically. Panels during installation are not secure and so provision for ensuring they do not cause a Health & Safety risk should be considered.
- Once all panels are installed on the wall, apply the final 'Z' channel(s) thus clamping the panels to the wall.
- 'Z' channels have visible fixings for the 'Z' to be secured to the wall but do not require any additional fixings to prevent panel removal. SuperPhon Hardface is clamped into position with the 'Z' profile thus cannot be removed unless the 'Z' channels are dismantled. It is recommended that anti tamper fixings are used to secure the 'Z' profile to the wall.

Typical installation procedure

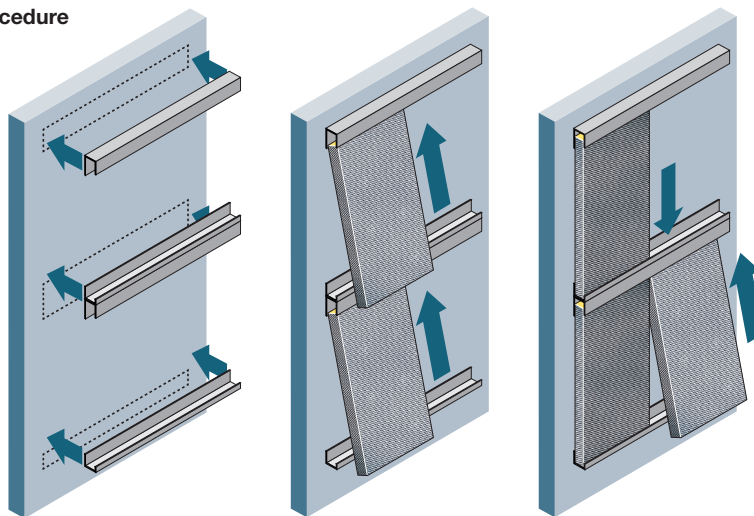

disclaimer: Please note that if powder coating has been applied to the panel surface some minor scratching may occur if care is not taken in the installation of this product.