

# KARMA Acoustiwall

## Installation Guide

Karma Acoustiwall 30mm Acoustic Wall Lining System reduces airborne sound through masonry walls and is installed directly to the wall without the need for timber battens or resilient bars. The system is primarily designed for the refurbishment of existing masonry walls where the original walls are to be converted into party or separating walls between dwellings. Karma Acoustiwall 30mm Acoustic Wall Lining System is especially useful in areas where space is of a premium in an existing property or where lightweight blocks have been installed in new properties.

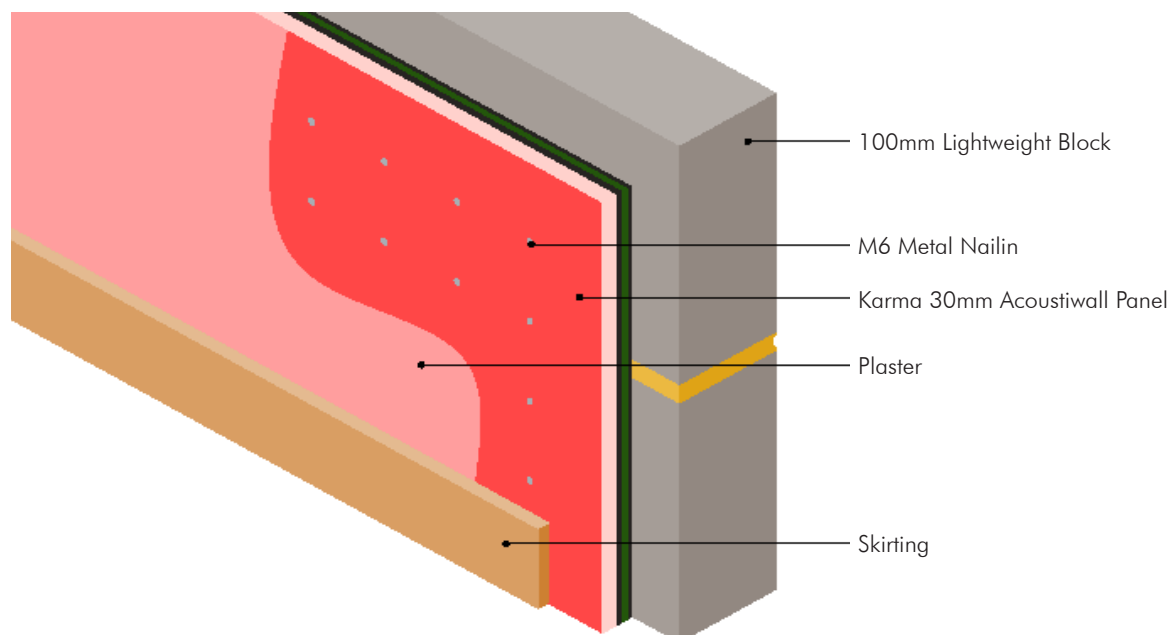

### Materials List

- Karma Acoustiwall 30mm Acoustic Wall Lining board (30 x 1200 x 1200mm)
- Acoustic/Fire mastic (310ml tube)
- M6 x 65mm Metal Nailins
- Taping and jointing materials / finish plastering materials

## Karma Acoustiwall

Direct to masonry wall solution (30mm Thickness) with M6 x 65mm Metal Nailins to new/existing block or brick walls.

### Description

Easy to fit, slimline solution for new/existing masonry walls where the original walls are to be converted into party or separating walls between dwellings

### Construction: New or Existing Masonry Walls

- Walls that require acoustic improvement to comply with the building regulations
- Wall finish - Taped and Jointed or finish plaster for decoration.

### General Information

- The entire wall structure is responsible for the direct transmission of sound through the separating wall. For the wall treatment, Karma Acoustiwall 30mm Acoustic Wall Lining System is the resilient layer which has good Airborne sound reduction values. However, if care and attention to detail are not carried out to a high standard, the overall performance will be affected.
- Flanking floors (floors connected to the separating wall) can carry both Airborne and Impact sounds to the rooms above and below or adjacent, so it is therefore very important to ensure all possible detachments of such junctions are paid attention. For further information of these junction details please contact the Karma Technical Team. This ensures that the Karma Acoustiwall 30mm Acoustic Wall Lining System provides the best possible performance.
- It is the fitter's responsibility to ensure all materials are safely and securely held.

## Karma Acoustiwall

### Installation Instructions (Read all steps before fitting)

- 1** The roof of the building and the windows must be in place prior to the installation of the Karma Acoustiwall Lining System.
- 2** Remove existing skirting, cornice/coving, sockets or switches. Ensure the top surface of the wall is flat and free of debris.
- 3** Offer up to the wall the Karma Acoustiwall panel, pink side facing out to ensure a flat and stable position.
- 4** Support the Karma Acoustiwall panel firmly against the wall whilst drilling 5x no. M6 holes, through the panel and into the block/brick wall, 200mm in and down from each corner and 1 no. to the centre.
- 5** Using a hammer, insert the 5no. M6 x 65mm Metal Nailin fixings through the panel into the block/brick behind to a depth where the head of the fixing slightly indents into the pink board flush with the surface.
- 6** Continue installing the Karma Acoustiwall panels in a brick fashion until the separating/party wall is completely covered ensuring minimal spaces/gaps between the abutted joints.
- 7** Apply the acoustic/fire mastic to all abutted joints and perimeter joints between floors, walls and ceilings.
- 8** Apply jointing tape to all board joints, apply finishing plaster ready for decoration.
- 9** Electrical Sockets/Switches: In areas which contain electrical sockets/switches ensure cables are brought through to the front of the Karma Acoustiwall panel using a minimal whole. Using the Acoustic/Fire mastic seal the whole around the cable, install suitable electrical boxes for plasterboard walls, install Karma Acoustic/Fire Putty Pads to the boxes, connect cables and affix switch/socket face plate.
- 10** Cornice/Coving: Install cornice/coving in the usual manner according to manufacturer's instruction.
- 11** Skirting Boards: Install skirting in the usual manner used with plasterboard partitions and according to manufacturer's instruction.

For further information and sales enquiries please call: 02380 625568

**KARMA**

