



Regupol®

TECHNICAL DATA SHEET

REGUPOL® 6010BA HIGH PERFORMANCE SCREED ISOLATION

PRODUCT DESCRIPTION

Manufactured from recycled crumb, Regupol® 6010BA is a high load bearing screed isolation solution. Delivering effective isolation and impact sound insulation, even under heavy loads, Regupol® 6010BA is often the preferred choice for premium developments and those where superior acoustic performance is critical.

APPLICATIONS

Regupol® 6010BA delivers a high end isolation solution for prestigious developments and areas where heavy loads are apparent. These include:

- Luxury apartments
- Penthouses
- Hotels
- Cinemas/Theatres
- Schools
- Hospitals
- Libraries
- Retail
- Gymnasiums



BENEFITS

- Independent Laboratory and Field Test Data available upon request showing compliance with Approved Document E Building Regulations (England & Wales) and Section H of the Scottish Building Regulations.
- Excellent impact and airborne performance
- Minimal creep, even under high loads
- Resistant to ageing and deformation
- Quick and easy to install
- Mildew and moisture proof
- Zero global warming potential (GWP) and zero ozone depletion potential (ODP)
- Product manufactured using Recycled Materials and 100% recyclable

WWW.CMSDANSKIN.CO.UK

CMSDANSKIN
ACOUSTICS

PHYSICAL INFORMATION

Sheet length	1.25m
Sheet width	10m
Material thickness	17mm nominal (dimpled one side)

TECHNICAL INFORMATION

Mean value of dynamic stiffness	15MN/m ³
Density	590kg/m ³
Tensile strength (DIN 53571)	approx 0.3N/mm ²
Thermal conductivity	approx 0.14W/mK
Elongation at break	approx 60%
Maximum load bearing capacity	5000kg/m ² (50kN/m ²)
Temperature resistance	-40°C to +110°C
Airborne sound insulation (DnT,w + Ctr)	62dB*
Impact sound insulation (L'nT,w (Ci))	40dB**

* Building Regulations Approved Document E requirements 45dB or greater result based on a tiled floor finish

** Building Regulations Approved Document E requirements 62dB or less result based on a tiled floor finish

INSTALLATION SERVICE

In addition to supply of this product, CMS Danskin Acoustics offers a competitively-priced installation service anywhere in the UK. Use of our service ensures that installation is performed to the highest standards by tradesmen fully experienced in the specialist skills of fitting acoustic materials correctly.

Please contact your local CMS Danskin Acoustics for further details.

INSTALLATION

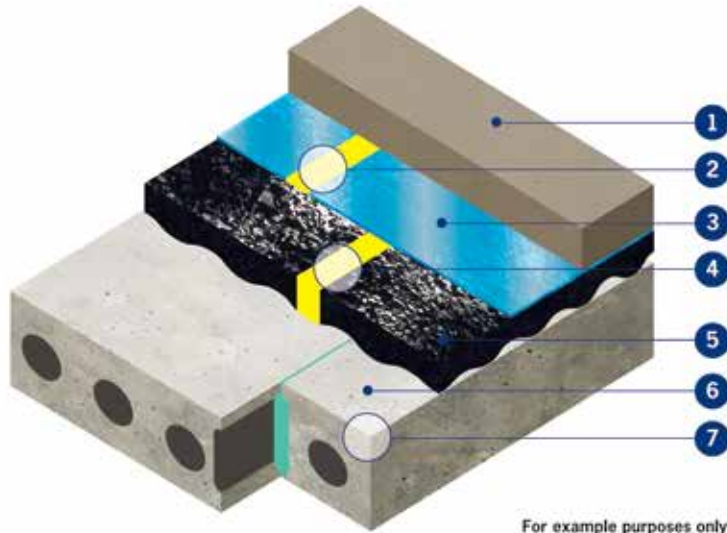

For example purposes only

CEILING VIEW

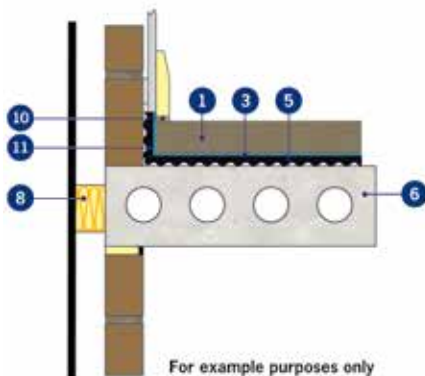

For example purposes only

1. 65mm sand cement screed
 2. Taped joint*
 3. 0.2mm waterproof membrane
 4. Joint detail (butted only)
 5. Regupol® 6010BA 17mm layer
 6. Pre-cast or beam and block floor, minimum 300kg/m²
 7. Perimeter detail
 8. Acoustic cavity closer
 9. Hi-tack tape
 10. Acoustic sealant
 11. Perimeter edge strip
- *DPM overlap to be minimum 100mm

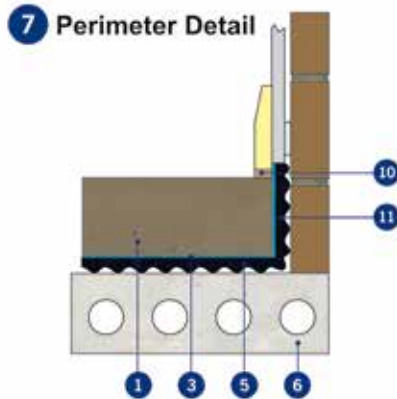

For example purposes only

4 Joint Detail (butted)

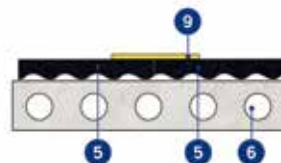

For example purposes only

Important Notes:

Regupol® 6010BA must be installed dimple side down.

CMS DANSKIN ACOUSTICS

Scotland Office: Tel: 01698 356000 Fax: 01698 372222
1 Netherton Road, Wishaw, ML2 0EQ

Central/Southern Office: Tel: 01925 577711 Fax: 01925 577733
Unit 2 Lyncastle Road, Appleton, Warrington, WA4 4SN

Email: info@cmsdanskin.co.uk Website: www.cmsdanskin.co.uk

IMPORTANT: Directions for use are given for guidance only and are not intended to form part of any contract. They should be varied or adapted to suit your particular materials or conditions of use. Goods supplied by the company are made to approved standards from the highest quality raw materials but no warranty or guarantee is given as to their suitability for any particular purpose or application, and no liability is accepted for any loss or damage arising directly or indirectly from the use of the Company's products irrespective of any information given to us as to intended use of such products. It is therefore recommended that prospective users should test a sample of this product under their own conditions to satisfy themselves that the product is suitable for the purpose intended.

CMSDANSKIN
ACOUSTICS