

# INSTALLATION GUIDELINES

## everroll® GYM FLOORING

### GENERAL INFORMATION

These laying instructions assume that the appropriate technical and physical skills required by national standard BS 8203:2017 will be used. These instructions correspond to the current knowledge of the manufacturer and are subject to modification. Neither the manufacturer nor the supplier of everroll® floor coverings and the requisite accessories, such as adhesive, banding or dampening strips have any direct influence over the correct laying and handling of the materials used.

The product liability for the quality of the everroll® floor covering delivered lies with the manufacturer, provided that no modifications or damage by third parties have taken place during or following delivery. Our General Terms and Conditions of Sale should be consulted in this regard.

Furthermore, the usage instructions and safety information from the adhesive manufacturer and the manufacturer of other accessories and ancillary materials used in the laying process must be observed.

### SUBSTRATE

The substrate for laying must meet the requirements of the relevant national standard. everroll® floor coverings can be laid on numerous different substrates. (screed, concrete, wood, asphalt, etc.) All substrates must be dry, resistant to pressure and tensile forces, even, clean, load-bearing, free from cracks, and contaminants (wax, solvents and paint, oil, lubricant, sealants and coatings, residual adhesive and other foreign bodies). The residual humidity of the substrate must meet the requirements of the adhesive. Appropriate system barrier coats must be determined separately for each object with the adhesive manufacturer.

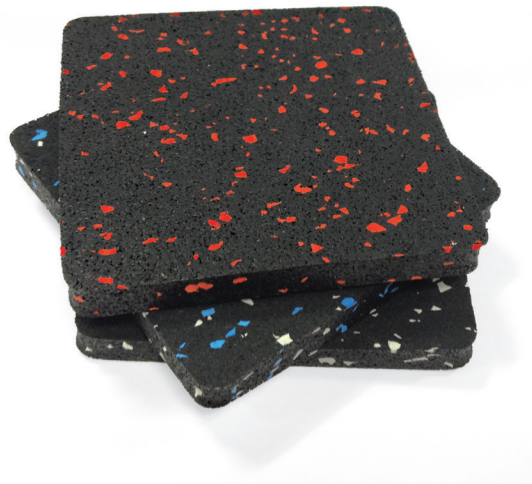

### MATERIAL TESTING

everroll® floor coverings are typically delivered packed as sheets and labelled. Individual rolls or puzzle tiles must be checked for completeness and absence of defects prior to commencing installation by the floor layer. Replacements may be provided solely for unlaied goods that have not been cut to size. Minor deviations in colour and design in nominatively identical everroll® floor coverings cannot be completely excluded. Any defects must be notified immediately to the supplier prior to the commencing of installation, providing both the order and batch number together with a description of the defect.

## LAYING RECOMMENDATION

Once the substrate has been correctly prepared, rolls required for the area to be laid must be rolled out completely without cutting. The floor covering should acclimatise over a period of approx. 8 hours at a constant ambient temperature of approx. 18-25°C.

Individual strips must be cut to size using a conventional carpet knife (cutter) and positioned precisely. The strip to be laid must be folded back by half in order to spread the adhesive coat onto the clean substrate. The product-specific instructions of the adhesive manufacturer must be followed.

The adhesive coat must be applied using the manufacturer's toothed spatula intended for the purpose and at right angles to the edge of the strips. Care should be taken to ensure that the adhesive is spread evenly across the entire surface. The relevant ventilation time must be determined in accordance with local weather conditions. The everroll® floor covering must be applied longitudinally to the adhesive coat with a maximum overlap of 2mm and pressed carefully into place with a pressure roller. The overlapping longitudinal edges must be pressed in carefully to ensure they fit snugly against the edge of the flooring strips already laid. Flooring strips must be installed progressively one after the other. Care should be taken to ensure that no adhesive in the joint area is pressed upwards to the surface. If any adhesive should come into contact with the surface, it should be removed immediately.

The interior of a roll is the surface or face side of the everroll® floor covering. Care should be taken to ensure that all strips are laid in the same direction and with the same face side up (always starting from the same wall). Individual strips must be arranged so that they are laid in the direction of greatest light exposure.

To achieve relatively airtight transitions in joint areas, the room temperature should remain constant and draughts should be avoided by the installer until the gluing process is complete. In addition, it is generally recommended that joints be weighted down during the adhesive curing period.

The longitudinal edges of everroll® coverings are manufactured by machine to ensure that the strips can be laid without having to adjust the edges further. Header joints on the other hand must be cut into a double cut or a V-cut prior to gluing.

## LOOSE LAYING

Loose laying of everroll® floor coverings as track segments to be taken back up again later is recommended only in certain circumstances. Please contact CMS Danskin Acoustics if a liftable surface is part of the design criteria.

everroll® Puzzle Tiles are laid loose on a firm substrate. Laying them on PVC surfaces is not recommended, as this can lead to discolouration. Please note, the matt surface is the topside of everroll® floor covering. The individual plates are joined together via the interlocking teeth to ensure that the overall surface is smooth and unbroken. Care should be taken to ensure that a sufficient distance from the wall of approx. 3cm is maintained when laying Puzzle Tiles.

## ADHESIVE

everroll® floor coverings as track segments should be installed using suitable, two-component PUR adhesives. In general, we recommend that the adhesive used be determined in consultation with the supplier for the property in question. Substrate treatment, trowelling and application must be done in accordance with the instructions for the adhesive used.

## AFTER INSTALLATION

After the everroll® floor covering is laid, it should not be used until the adhesive has hardened. Experience has shown that this will typically take 24 hours. The ambient temperature should be kept constant and draughts should be excluded until the adhesive has dried completely. Heavy point loads or rolling loads can lead to shifting or deformation of the surface if the adhesive has not fully dried. During the ongoing construction phase, the everroll® floor covering should be protected against dirt and damage incurred from the performance of other work. A rubber-compatible protective layer should be used. Finally, depending on the venue, the surface should be cleaned thoroughly with a rotating brush cleaner.

## BONDING OF RESILIENT LAYERS FOR ACOUSTIC FLOORS (GYMS)

### Preparation

Following on from the above, there is a procedure to follow for specialist Gym floor build ups. The area in question should be flat and smooth, swept clean and dry as per the manufacturers recommendations. Everroll Compact/Impact rolls (all thicknesses) should be left to acclimatise as above.

### Perimeter (Acoustics)

A 5-10mm perimeter strip (Red area on Drawing 1) should be installed to all internal/external wall and any columns present. This provides a separation between any stiff floor finishes and the surrounding structure and to prevent the possibility of impact noise travelling to other areas within the building.

### Acoustic Floor Build Up

For acoustic build ups, layers should be laid as per the test carried out, or the specification that is in place for the individual gym (usually detailed in the acoustic report). This means products should be placed in the same order as tested from top to bottom.

### Bonding Layers

Where a multi-layer build up is required, all joints should be staggered between layers. Layers should be bonded where necessary, Drawing 1) provides examples of this.

When bonding multilayer build ups and/or Everroll to concrete/timber floors, we recommend using our Ultrabond Eco S955 Adhesive (Yellow areas on Drawing 1) with a 3mm Notched Trowel. A weighted roller should be used to provide full coverage bonding. Reference should be made to the manufacturer recommendations above. Where more than one layer of adhesive can be present in a build up, it is recommended that the same adhesive is used so each layer has the same bond strength.

Finish floor surfaces such as Everroll MultiTile and Everroll Weightlayer often don't require bonding with adhesive; these should be laid in brick fashion and joined with the dowels provided. If bonding is a requirement then the same Ultrabond Eco S955 Adhesive should be used.

### Additional floor Coverings

When other floor coverings such as vinyl, capret tiles etc. might be desired over an acoustic build such as those shown in Drawing 1), the supplier of these coverings must be consulted as to the suitability of their product in conjunction with the layers below. CMS Danskin Acoustics can supply materials if desired for any necessary tests.

### Maintenance and Cleaning

Please see separate Maintenance and Cleaning information.

### Drawing 1

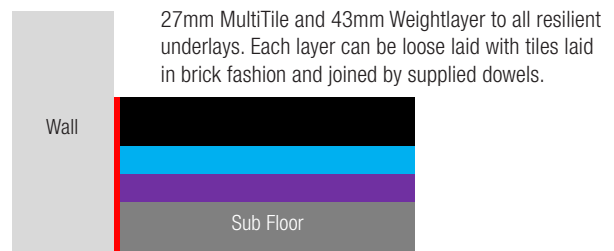
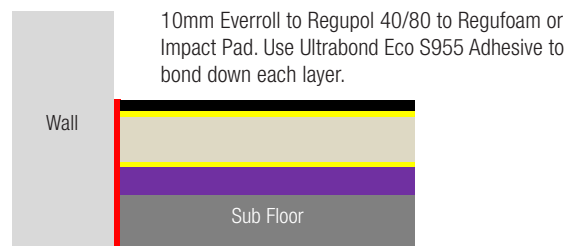
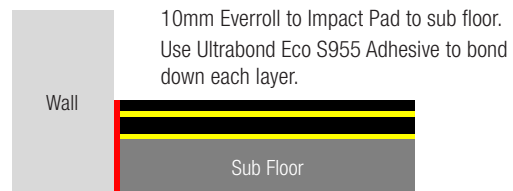
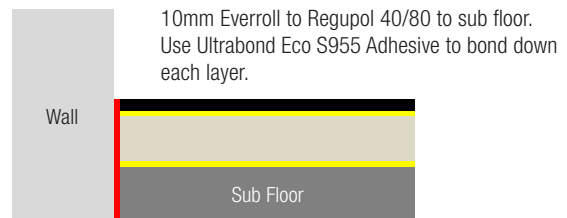
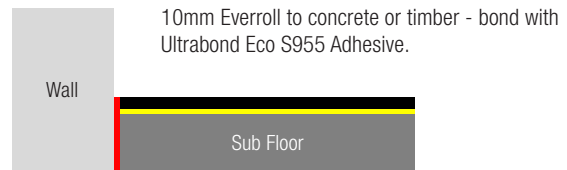

## CMS DANSKIN ACOUSTICS

Scotland Office: Tel: 01698 356000 Fax: 01698 372222  
1 Netherton Road, Wishaw, ML2 0EQ

Central/Southern Office: Tel: 01925 577711 Fax: 01925 577733  
Unit 2 Lyncastle Road, Appleton, Warrington, WA4 4SN

Email: [info@cmsdanskin.co.uk](mailto:info@cmsdanskin.co.uk) Website: [www.cmsdanskin.co.uk](http://www.cmsdanskin.co.uk)

**IMPORTANT:** Directions for use are given for guidance only and are not intended to form part of any contract. They should be varied or adapted to suit your particular materials or conditions of use. Goods supplied by the company are made to approved standards from the highest quality raw materials but no warranty or guarantee is given as to their suitability for any particular purpose or application, and no liability is accepted for any loss or damage arising directly or indirectly from the use of the Company's products irrespective of any information given to us as to intended use of such products. It is therefore recommended that prospective users should test a sample of this product under their own conditions to satisfy themselves that the product is suitable for the purpose intended.

**CMSDANSKIN**  
ACOUSTICS