

INSTALLATION GUIDELINES

Installation Guidelines

Vertical Installation using U Channel Secret Fix (Demountable)

- 'U' Channels are to be located on the substrate with suitable fixings to suit background in a location that is appropriate to the desired installation. Fixings should be applied through the long leg of the channel as the installation guide shows.
- Vertical installation of Superphon HardFace secret fix installation uses Top and Bottom channels that allow panels to be lifted into the top channel and lowered into the bottom frame. The large Top Channels can be used if desired at each side. This allows a "picture frame" to be constructed and provides some tolerance to the installation as the panels can be adjusted. Installation should start by installing panels to each side of the wall working towards the centre. The last panel can be inserted by adjusting panels either side.
- Panels installed vertically are butt jointed.
- Panels can also be installed and moved along the channels to allow even spacing between panels if a shadow gap appearance is desired.

Options using this system are below but are not easily demountable and only partially secret fixed.

- To prevent unwanted removal of the panels, self drilling screws or rivets can be used through the channel face to secure the Superphon HardFace. These fixings are obviously visible.
- It is possible to use the U channel to the bottom (and sides if desired) and Z profile to the top. This then prevents panels from being removed as the Z profile does not allow panel movement upwards preventing panels being lifted and removed. The fixings in the Z profile are visible. Z profile would be the last part of the installation to be fixed.



Description

SuperPhon HardFace is a highly sound-absorbent acoustic treatment encased in perforated, galvanised steel, making it suitable for high-traffic areas and environments where vandalism may be an issue, such as prisons, police stations and industrial areas.

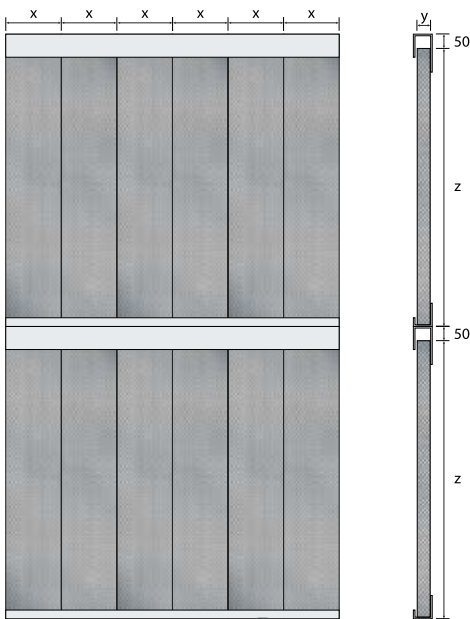

x (width) = 300/450/600mm
y (thickness) = 50/75/100mm
z (height) = dependent on height of wall

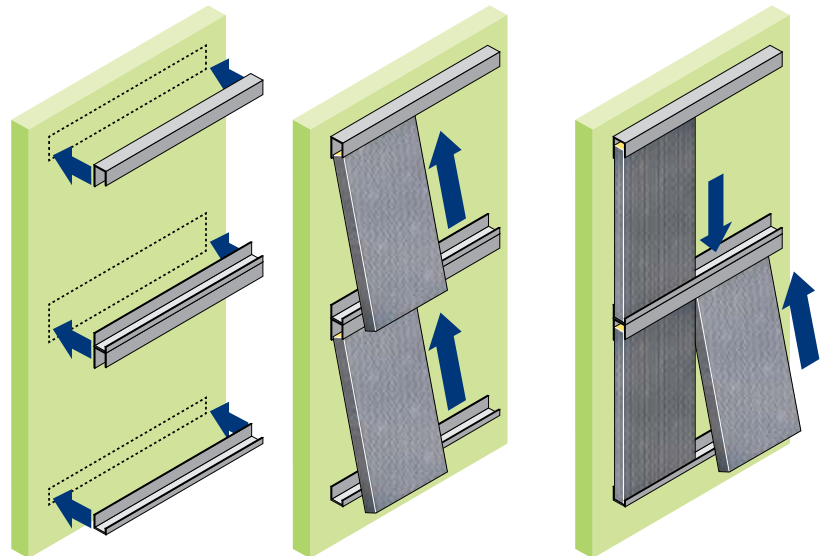

Typical installation procedure

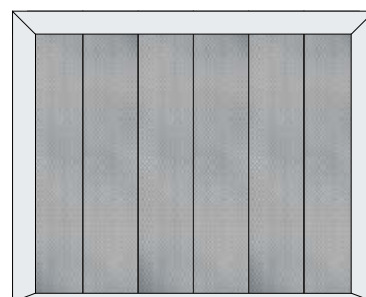

Typical 'picture frame' construction.

Secondary fixings may be required to prevent movement of the panels if contact is made with them.

Typical panel layout when panels need to be installed above each other due to elevation height requiring treatment.

Please ring CMS Danskin on **01925 577711** for technical advice.

'U' channel and/or 'Z' channel options

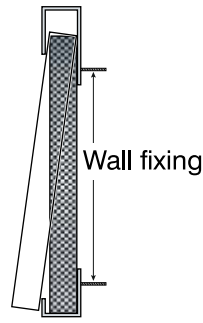

'U' channel fixing method

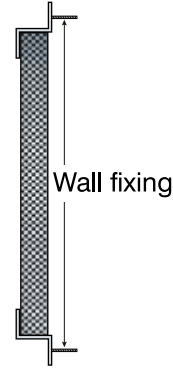

'Z' channel fixing method

Horizontal Installation using U Channel (not available in secret fix)

- U Channels are to be located on the substrate with suitable fixing arrangement to suit background in a location that is appropriate to the desired installation. Fixings should be applied through the Long leg of the channel as the installation guide shows.
- Horizontal installation would start from the bottom with the first panel inserted into the large channels to the side and adjusted to ensure the panel ends are within the channel and then lowered into the bottom channel. Subsequent panels are installed, stacking each panel on top of the preceding.
- The penultimate panel should be installed between the side U channels but then pushed up into the top channel. The final panel will then be installed allowing the previous panel to be dropped down on top the stack of panels completing the wall.
- All panels will require self drilling screws or rivets applying through the side U channels to ensure the panels cannot come out of the U channels.

Vertical or Horizontal Installation using Z channel (not secret fix)

- Z Channels are to be located on the substrate with suitable fixing arrangement to suit background in a location that is appropriate to the desired installation. Only apply the Z channel the bottom (or to the bottom and one edge). The Z to the top (and one side) should be the last part of the installation.
- Install HardFace panels in the desired orientation Horizontally or Vertically. Panels during installation are not secure and so provision for ensuring they do not cause a Health & Safety risk should be considered.
- Once all panels are installed on the wall, apply the final Z channel(s) thus clamping the panels to the wall.
- Z channels have visible fixings for the Z to be secured to the wall but do not require any additional fixings to prevent panel removal. Superphon HardFace is clamped into position with the Z profile thus cannot be removed unless the Z channels are dismantled. It is recommended that anti tamper fixings are used to secure the Z profile to the wall.

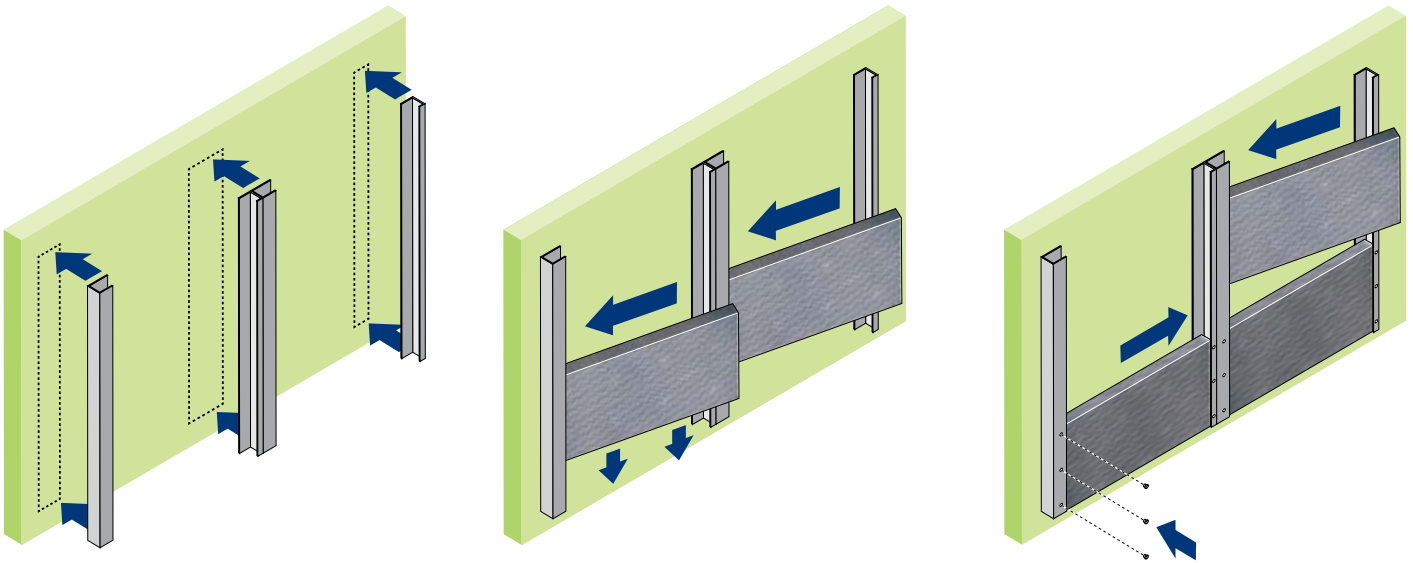

Typical installation procedure

Installation Service

In addition to supply of this product CMS Danskin Acoustics can provide a listing of competitively-priced approved installers that service anywhere in the UK. Use of this service ensures that installation is performed to the highest standards by tradesmen fully experienced in the specialist skills of fitting CMS Danskin acoustic materials correctly. Please contact CMS Danskin on **01925 577711** for a list of approved and qualified installers.

Disclaimer

Please note that if powder coating has been applied to the panel surface some minor scratching may occur if care is not taken in the installation of this product.

IMPORTANT: Directions for use are given for guidance only and are not intended to form part of any contract. They should be varied or adapted to suit your particular materials or conditions of use. Goods supplied by the company are made to approved standards from the highest quality raw materials but no warranty or guarantee is given as to their suitability for any particular purpose or application, and no liability is accepted for any loss or damage arising directly or indirectly from the use of the Company's products irrespective of any information given to us as to intended use of such products. It is therefore recommended that prospective users should test a sample of this product under their own conditions to satisfy themselves that the product is suitable for the purpose intended.

Scotland Office:

1 Netherton Road, Wishaw ML2 0EQ

Central/Southern Office:

Unit 2 Lyncastle Road, Warrington, Cheshire WA4 4SN

email: info@cmsdanskin.co.uk website: www.cmsdanskin.co.uk

t: 01698 356000 f: 01698 372222

t: 01925 577711 f: 01925 577733